



PLAN
Scale — 1" = 40'

DATUM
All Elevations shown in Red Ink are in Feet and are above a Plane which is 1045.28 Ft. below the City Bench Mark as established by Ordinance No. 383, City of San Bernardino.

CONNECTING SEWERS
All Connecting Sewers shall be laid on an upward grade of five percent and shall be constructed between the main sewer and the property line and shall be at right angles to the main sewer.

TITLE TO STREET
Virginia St. dedicated to City of San Bernardino as Virginia Avenue by Virginia Square Subdivision. Recorded in Book 23 of Maps, Page 84.
Name of Virginia Ave. changed to Virginia St. by Resolution No. 163, November 3, 1930.
Virginia St. also dedicated to City of San Bernardino by Ord. May 4, 1931. Recorded in Deeds Book 7170R, Page 566.

GRADE
Grade of Virginia Street established by Ordinance No. 1022, 7-13-1928, also, by Resolution No. 185-5-29-31.

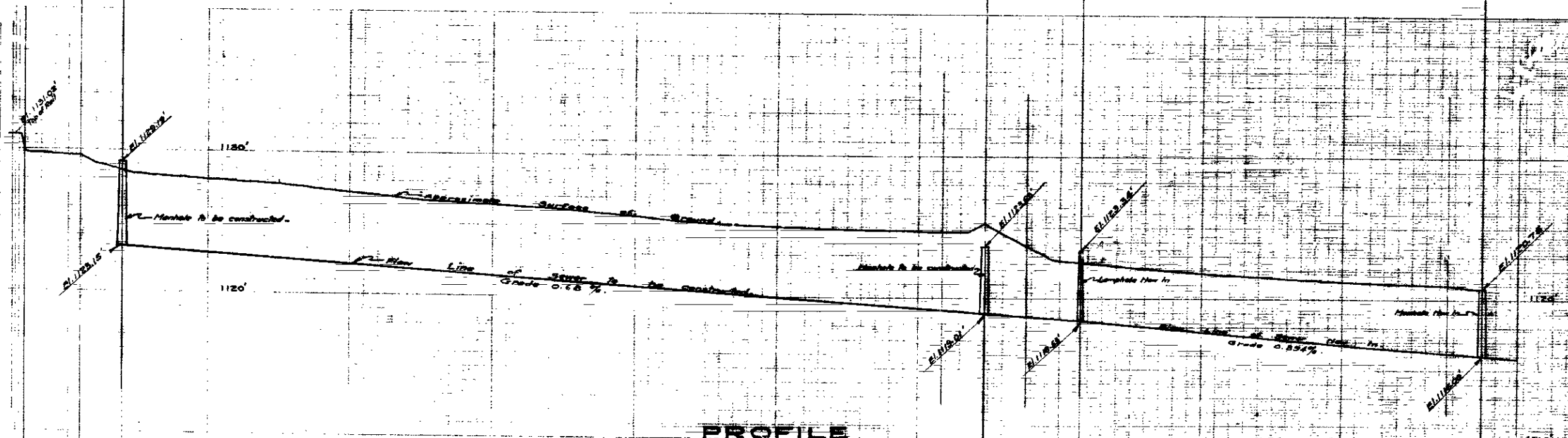

PROFILE
Scale — Horizontal — 1" = 40'
Vertical — 1" = 4'

PROFILE LEGEND
Black Line shows Approximate Present Surface of Ground, thus;
Red Line shows Elevation Line of Sewer to be constructed, thus;

JUNE 1, 1931
[Signature]



PLAN
Scale — 1" = 40'

DATUM
All Elevations shown in Red Ink are in Feet and are above a Plane which is 1045.28 Ft. below the City Bench Mark as established by Ordinance No. 383, City of San Bernardino.

CONNECTING SEWERS
All Connecting Sewers shall be laid on an upward grade of five percent and shall be constructed between the main sewer and the property line and shall be at right angles to the main sewer.

TITLE TO STREET
Virginia St. dedicated to City of San Bernardino as Virginia Avenue by Virginia Square Subdivision. Recorded in Book 29 of Maps, Page 84.
Name of Virginia Ave. changed to Virginia St. by Resolution No. 163, November 3, 1930.
Virginia St. also dedicated to City of San Bernardino by Ord. May 4, 1931. Recorded in Deeds Book 7170R, Page 566.

GRADE
Grade of Virginia Street established by Ordinance No. 1022, 7-13-1928, also, by Resolution No. 185-5-29-31.

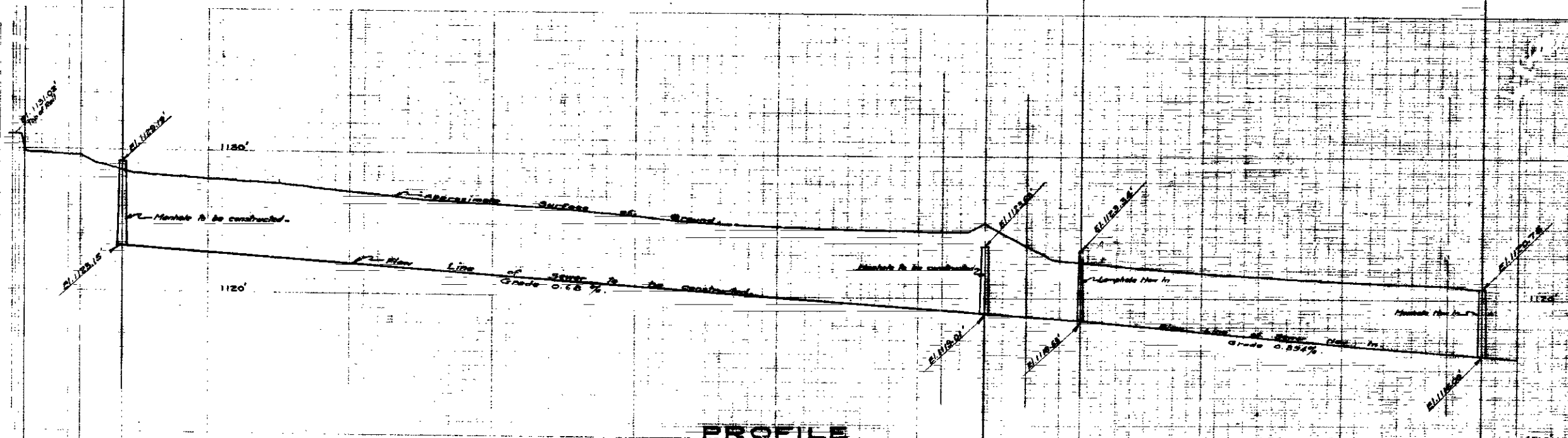

PROFILE
Scale — Horizontal — 1" = 40'
Vertical — 1" = 4'

PROFILE LEGEND
Black Line shows Approximate Present Surface of Ground, thus;
Red Line shows Elow Line of Sewer to be constructed, thus;

JUNE 1, 1931
[Signature]